

Bontanica MODEL: D Plan 4 - 3395 Sq.Ft. Sq.Ft. (Approx)

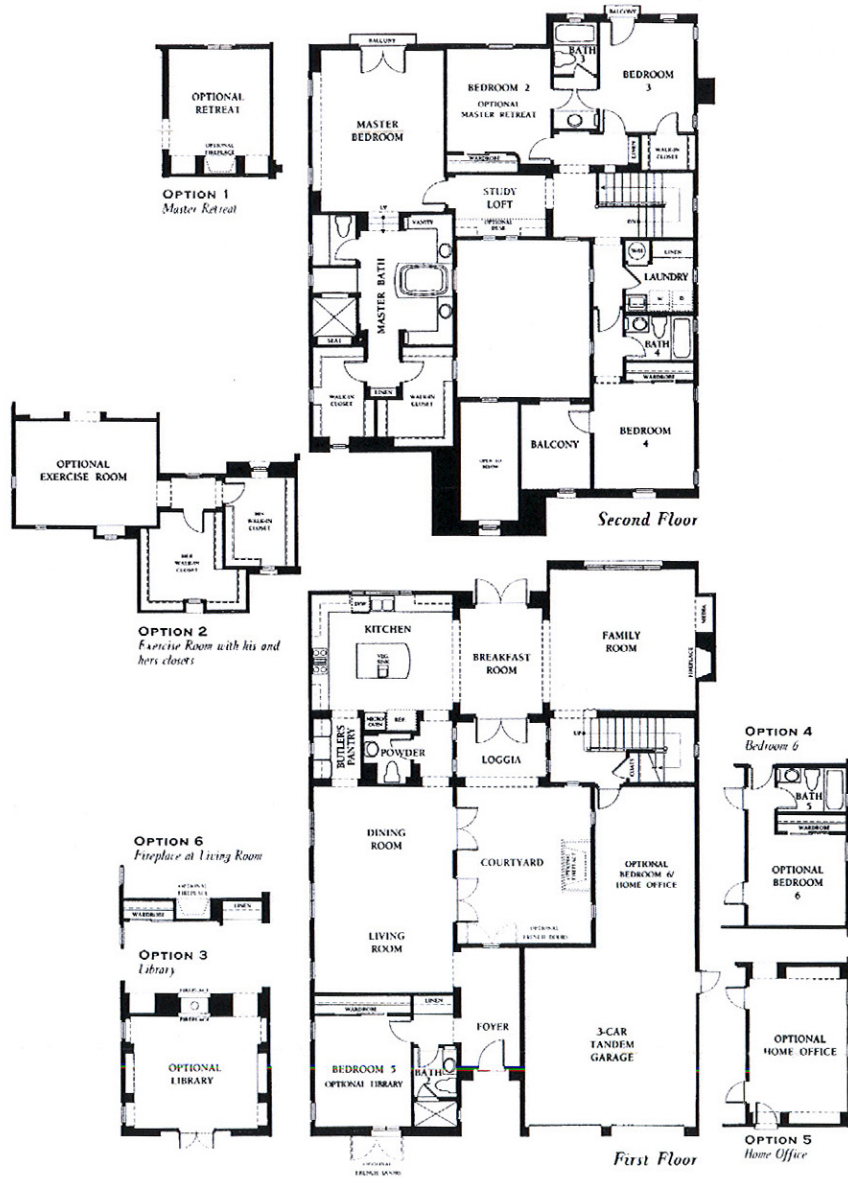

- APPROXIMATELY 3,395 SQUARE FEET
- TUSCAN COUNTRY OR FRENCH PROVENCAL ARCHITECTURE
- TWO STORY
- ELEGANT FORMAL ENTRY FOYER
- COMBINATION LIVING AND DINING ROOMS
- GOURMET KITCHEN WITH ISLAND
- SEPARATE BREAKFAST ROOM WITH FRENCH DOORS TO THE LOGGIA AND BACKYARD
- SPACIOUS FAMILY ROOM
- ATRIUM COURTYARD
- FIVE BEDROOMS
- FOUR AND ONE-HALF BATHS (UP TO SIX BEDROOMS AND FIVE AND ONE-HALF BATHS WITH OPTIONS)
- STUDY LOFT
- OPTIONAL LIBRARY
- OPTIONAL HOME OFFICE
- OPTIONAL MASTER RETREAT
- OPTIONAL EXERCISE ROOM
- OPTIONAL BEDROOM SIX
- THREE-CAR TANDEM GARAGE